

THIS DRAWING IS THE PROPERTY OF SOVIBRANT LIMITED AND MUST NOT BE COPIED OR OTHERWISE REPRODUCED

ALL DIMENSIONS MUST BE CHECKED ON SITE BEFORE COMMENCING WORK. NO DIMENSIONS TO BE SCALED FROM THIS DRAWING

SOVIBRANT ARE NOT RESPONSIBLE FOR THE ACCURACY OF INFORMATION RECEIVED FROM OTHERS TO PRODUCE THIS DRAWING UNLESS A FULL SITE SURVEY IS UNDERTAKEN

LAYOUTS SUBJECT TO BUILDING CONTROL APPROVAL

**NOTES:**

THIS RECOMMENDED OPTION IS BASED ON THE MAJORITY OF THE TEAMS BASED IN THE AMENITIES BLOCK BEING RELOCATED TO THE ECO DEPOT BUILDING.

BASED ON RECENT DISCUSSIONS REGARDING WORK DISTRIBUTION THIS OPTION ASSUMES THAT ALL WORK DISTRIBUTION CAN TAKE PLACE IN ONE AREA WHICH IS SHOWN ON THE PLAN

A NEW SHOWER ROOM AND TEA POINT HAVE BEEN PROPOSED IN ORDER TO BRING THE SPACES IN LINE WITH THE WEST OFFICES DEVELOPMENT







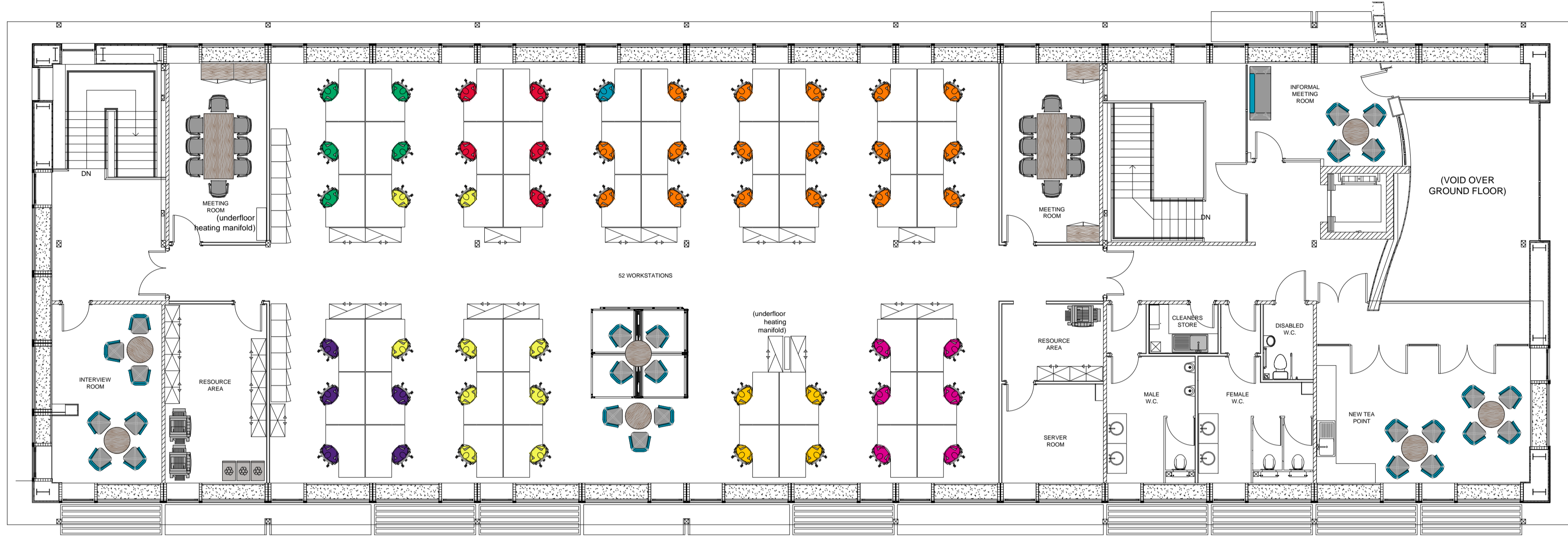

-  CANS 17a  
NPS & COMMUNITY PAYBACK
-  CANS 17b (6 desks)  
PARKS AND OPEN SPACES (FROM CANS 07)
-  CANS 17c, 17d, 17g, & 17h  
HIGHWAYS TEAM
-  CANS 17e  
HIGHWAY INSPECTOR
-  POTENTIAL NEW TEAM  
TRANSPORT PROJECTS TEAM  
(NOTE: WOULD RESULT IN 6 FREE WORKSTATIONS AT WEST OFFICES)
-  CANS 17f  
HIGHWAY ARCHITECTS/DRAFTSMEN
-  CANS 13  
STREET ENVIRONMENT SERVICES
-  HOT DESKS
-  8 No. 2000h STORAGE UNIT  
5 LM PER UNIT - 40 LM
-  16 No. 1200h TAMBOUR UNIT  
3 LM PER UNIT - 48 LM
-  4 TIER LOCKER

**TOTALS:**

52 WORKSTATIONS  
88 LINEAR METRES OF STORAGE  
52 LOCKERS

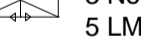

FIRST FLOOR

-  CANS 12 & 15  
WASTE & FLEET SERVICES
-  CANS 08c  
HOUSING ASSET MANAGEMENT
-  CS 05  
PROPERTY SERVICES & FM
-  REF ???  
YARD FOREMEN
-  CANS 16  
BUILDING MAINTENANCE ASSET MANAGEMENT
-  HOT DESKS
-  3 No. 2000h STORAGE UNIT  
5 LM PER UNIT - 15 LM
-  21 No. 1200h TAMBOUR UNIT  
3 LM PER UNIT - 63 LM
-  4 TIER LOCKER
-  WORK ISSUE LOCKERS

**TOTALS:**

48 WORKSTATIONS  
78 LINEAR METRES OF STORAGE  
48 LOCKERS

**NOTE:**  
CBSS 23 New Facilities Team to be located here. D.A. to advise on workstation allocation

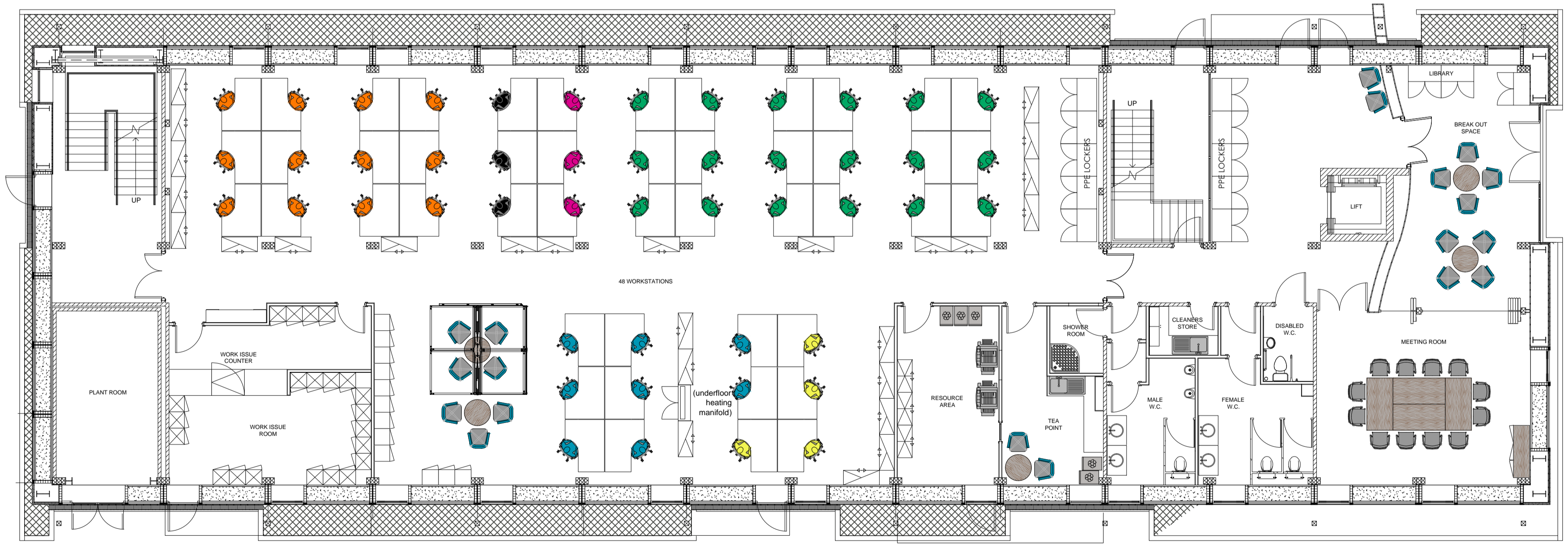

GROUND FLOOR

| REVISIONS | DATE     | DESCRIPTION        | BY  |
|-----------|----------|--------------------|-----|
| D         | 13.07.12 | GENERAL AMENDMENTS | PP  |
| C         | 14.06.12 | FOR COSTING        | CRH |
| B         | 24.05.12 | GENERAL AMENDMENTS | PP  |
| A         | 09.05.12 | FIRST ISSUE        | CRH |

**sovibrant**

SoVibrant Ltd  
Hornbeam House  
Hornbeam Park  
Harrogate  
England  
HG2 8QT

tel: (+44) 01423 855910

CLIENT:  
CITY OF YORK COUNCIL

PROJECT:  
ECO DEPOT  
REFURBISHMENT

SITE LOCATION:  
HAZEL COURT  
YORK

DRAWING:  
GENERAL ARRANGEMENT

| SCALE:      | DATE:    | DRAWN BY: |
|-------------|----------|-----------|
| 1:100 at A1 | 01.02.12 | PP        |
| DRAWING No: | REV:     |           |
| 8403-FO-112 | D        |           |

FOR APPROVAL